

Assembly Instructions for

# **TWX-2030**

# **Rock Island Freight House**

**TW Trainworx  
2808 McGowan St  
Dallas, TX 75203  
(214) 634-2971**

## Recommended paints

You will find throughout this manual we recommend specific colors to paint the various parts and at which stage to paint them. This is to guide you to creating a model that looks like the one on the cover. In addition to this manual we also have a YouTube video that walks you through the weathering techniques we used on our model. Just visit the TW Trainworx YouTube channel and search for “TWX-2030”.

We recommend the use of enamel based spray paints. It is very important that these paints be used outdoors in a well ventilated area, the fumes can be harmful to you and others around you, so please only use these paints in an outdoor space.

The paints we recommend in this manual (and the YouTube video) are outlined below. The spray paints can be obtained from any Do-it-yourself store. The acrylic paints are used for dry brushing (and explained in the video) these can be purchased from any craft store. (The acrylic paints can be used indoors and do not have any odor or fumes.)

### **Spray Paints** (can be found in any DIY store)

Rustoleum® Matte Clear Enamel (Part number 285093)  
Rustoleum® Satin finish Almond (Part number 7758)  
Rustoleum® Satin finish Spruce Green (Part number 7737)  
Rustoleum® Satin finish Satin Cabernet (Part number 248635)  
Rustoleum® Satin finish Dark Brown (Part number 241239)  
Rustoleum® Gloss finish Charcoal Gray (Part number 7784)  
Valspar® Satin finish Leafy Rise (Part number 84226)

### **Acrylic Craft Paints** (can be found in any craft store)

Americana® Neutral Grey (Part number DAO95)  
Americana® Slate Grey (Part number DAO68)  
Americana® Grey Sky (Part number DA111)  
Americana® Desert Cactus (Part number DA331)  
Americana® Bleached Sand (Part number DA257)  
Americana® Rockwood Red (Part number DA097)  
Americana® Russet (Part number DA080)  
Americana® Burnt Sienna (Part number DA063)

### **(For wooden dock floor weathering)**

Americana® Burnt Umber (Part number DAO64)  
Americana® Milk Chocolate (Part number DA174)  
Americana® Sable Brown (Part number DAO61)  
Americana® Cocoa (Part number DA259)

### **Materials for applying washes**

Odorless Turpenoid (only available at craft and art supply stores)  
Ivory Black Oil Paint (we use Windsor & Newton, but any brand will work)  
Burnt Sienna Oil Paint (any brand will work)

### **Adhesives;**

Super glue (we recommend a medium viscosity cyanoacrylate adhesive)  
Accelerator (this is a liquid that accelerates the drying time of any super glue and comes in a spray bottle)  
Wood glue (we recommend Tite Bond® II Wood Glue for gluing the wood components)

There are two decisions you need to make before beginning the construction of this kit;

- 1.) Will you position any of the dock doors in an open position?
- 2.) If the answer is yes, do you want a wooden dock floor or a concrete dock floor?

Once you have made your decision, turn the page and let's get started!

You can find an online painting tutorial for this structure by logging on to **You Tube**, go to the TW Trainworx channel and look for the "TWX-2030 Painting Tutorial Video". This video walks you through the paints and methods we used to decorate the model we show in all our advertising materials.

### **Step 1: Assemble the dock floor**

*C3 Dock floor (1pc)*

*A7 Dock floor supports (4pcs)*

**\*\*** Do you want a wooden dock floor or a concrete warehouse floor? Now is the time to make this decision, if you choose a wooden floor, glue the supports to the smooth side of the dock floor. If you prefer a concrete floor, glue the supports to the engraved side of the dock floor.

- a. Glue the four floor supports (A7) to the dock floor (C3) using wood glue. Insert the interlocking tabs on the ends of the supports into the square mounting holes on the dock floor. There are 4 floor supports in total.
- b. Using a can of spray paint, paint the dock floor dark gray primer (if you chose a concrete floor) or brown if you chose the wooden floor. We recommend using Rustoleum® Charcoal Gray (#7784) for concrete surfaces and Rustoleum® Dark Brown (#241239) for wooden surfaces. (The dock floor supports do not need to be painted.)

**The VIDEO explains how to dry brush these surfaces.**

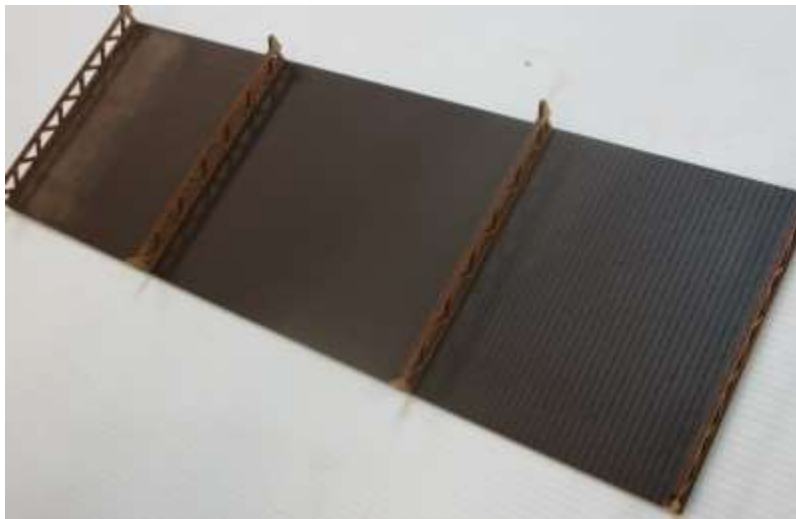

### **Step 2: Assemble the roof**

*C2 Roof (1 pc)*

*C1 Roof support (2pcs)*

- c. Install the LED Light Strip to the inside top of the roof (the roof is reversible, so it does not matter which side you chose at this stage) by removing the protective paper and adhere to the inner roof surface. Light strip must be installed in the center of the roof (to fit under the chases in the support pieces).

- d. Glue the roof supports (C1) to the inside of the roof (C2) using wood glue. We recommend using a miniature square to ensure the roof supports are perpendicular with the roof (this will be a requirement when assembling the structure later on).
- e. Paint only the top of the roof (opposite the LED light strip) with spray paint. We recommend Rustoleum® Charcoal Gray (#7784) as this will be a base for the gravel application at the end of the manual.

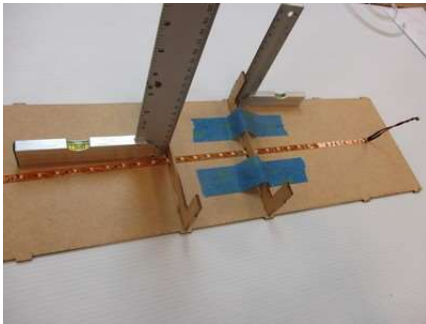

### Step 3: Prepare the inner walls of the structure

*B1 Front inner wall (1pc)*

*A6 Truck inner wall (1pc)*

*B2 Rear inner wall (1pc)*

*D15 Track inner wall (1pc)*

*D9 Dock office interior wall (1pc)*

- a. Remove the five wall Sections; B1; front wall, A6; truck wall, B2; rear wall, D15; track wall and D3; interior dock office wall.
- b. Ensure the sprues (the small sections of material that hold the wall to the panel) have been sanded down so the wall edges are smooth.
- c. Paint the interior walls (the side of the walls with no brick detail) in the dock area, we suggest a pale green color for the interior walls, such as Valspar® Leafy Rise (#84226). This includes A6, B2, D15 and D3. (only paint the inner walls near dock area and the dock office wall).

### Step 4: Assemble the inner main structure

\*\*\*Note: when working with wood glue you want to keep a wet rag handy to wipe up any excess glue that can be pushed out of the seams. Waiting for the glue to dry will yield undesirable results!

- a. Position the track wall (D15) with the brick detail facing down on the table top. Insert the roof and supports into the track wall (no glue is required for this step). **\*\*NOTE: The diode/wired end of the LED light strip should be positioned closest to the front wall (B1).**
- b. Apply a small bead of wood glue to the left edge of the front wall (B1) and insert the tabs into track wall (D15) ensuring the brick detail is facing outward.
- c. Place 3 pieces of tape around the edge between D15 and B1 to help keep the seam tight. **\*\*Wipe off any wood glue that has pressed out of the joint.**

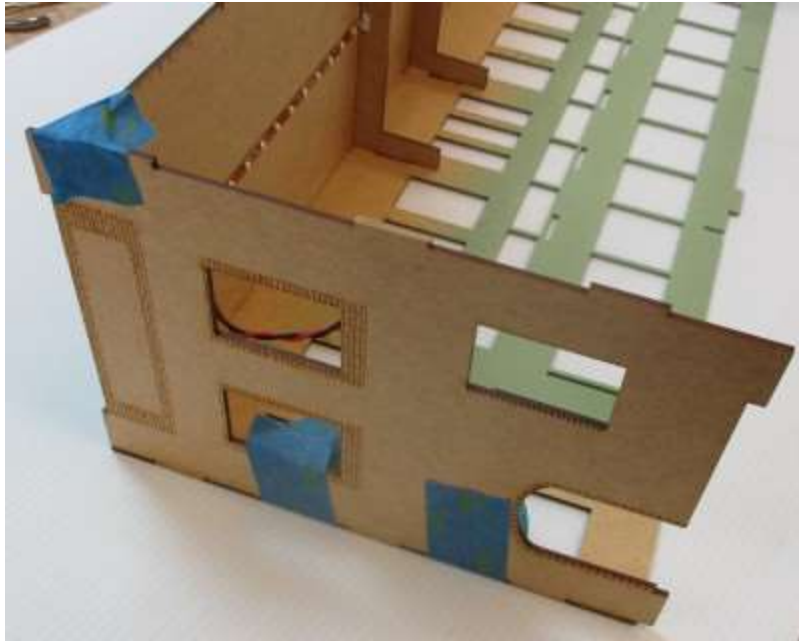

- d. Apply a small bead of wood glue to the right edge of front wall (B1).
- e. Stand the structure up on the table top, with the roof facing down.
- f. Insert the tabs of the dock wall (A6) into front wall (B1) ensuring the brick detail is facing outward. Be sure to include the roof tabs (and support tabs).
- g. Place three pieces of tape around the edge between B1 and A6 to help keep the seam tight. *\*\*Wipe off any wood glue that has pressed out of the joint.*

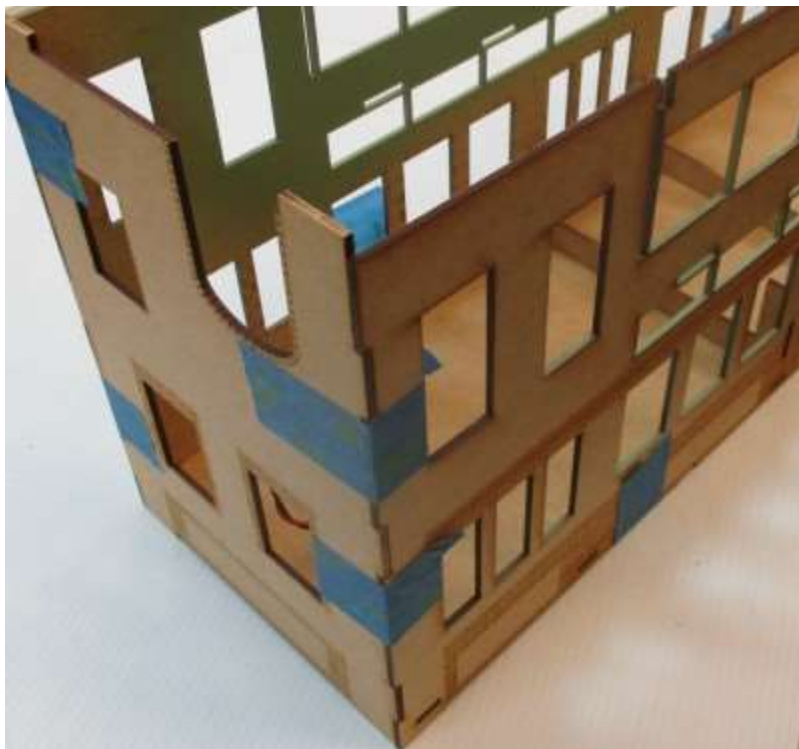

- h. Apply wood glue to both the right and left sides of rear wall (B2).
- i. Carefully insert rear wall (B2) into track wall (D15) and truck wall (A6) ensuring the brick detail is facing outward.
- j. Place 3 pieces of tape on each corner to keep the seams tight.

*\*\*Wipe off any wood glue that has pressed out of the joint.*

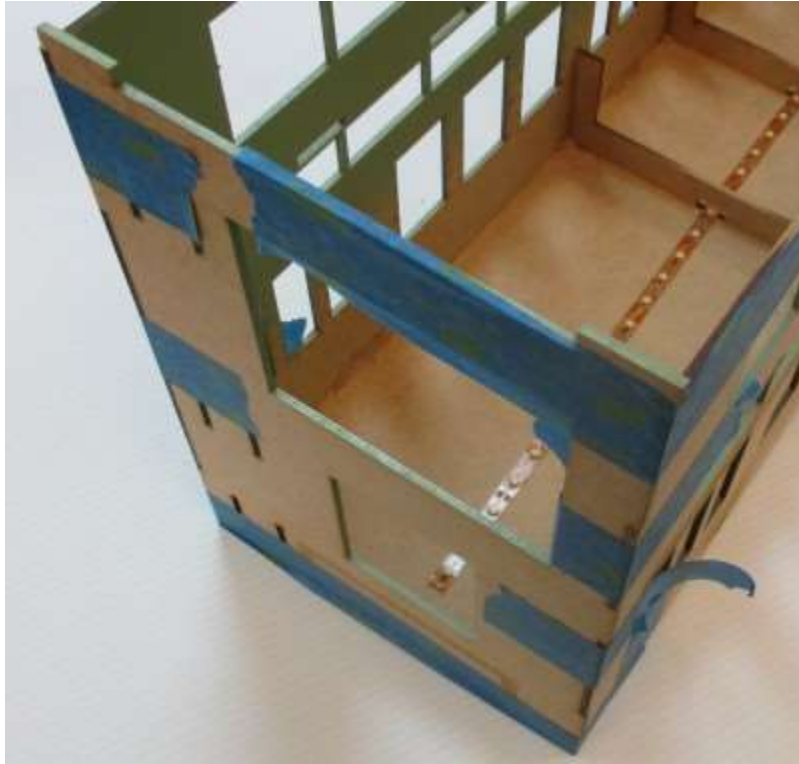

- k. Locate the interior office wall (D9) and insert it into the slot in the track wall (D15) and the truck wall (A6) \*\* the door and window detail should face the dock area. The wall will fit snugly in place, if you feel adhesive is required apply a small dab of super glue each bottom corner (in the office interior, closest to the front wall).



- l. Wait approximately 30 minutes for the wood glue in the four corners to dry completely.  
m. Once completely dry remove the tape from all corners. Sand off any excess wood glue present.

#### **Step 5: Assemble the smoke stack**

- B8 RH smoke stack wall (1pc)*
- B9 Outside long smoke stack wall (1pc)*
- B10 LH smoke stack wall (1pc)*
- B11 Inside short smoke stack wall (1pc)*

Locate the four walls of the smoke stack B8, B9, B10 and B11. Remove them from the panel and clean up the sprues (so the edges are smooth).

- a. Apply a small bead of wood glue to the long edge of B8 (the edge with four  $\frac{1}{4}$ " tabs).
- b. Insert B8 into B9 (the stack will only interlock in one orientation which aligns the top and bottom edges of the stack).
- c. Wipe any excess glue that presses out of the joint (on the exterior surface only)
- d. Apply several small pieces of tape around this corner to help keep the joint tight.
- e. Apply a small bead of wood glue to the long edge of B10 (the edge with four  $\frac{1}{4}$ " tabs).
- f. Insert B10 into B9 (the stack will only interlock in one orientation which aligns the top and bottom edges of the stack).
- g. Wipe any excess glue that presses out of the joint (on the exterior surface only)
- h. Apply several small pieces of tape around this corner to help keep the joint tight.
- i. Locate the short wall of the smoke stack (B11). Place it into the interlocking tabs of B8 and B10, using a pencil mark the bottom edge of B11 on the edges of B8 and B10 (to use a boundary for applying wood glue).
- j. Apply a small bead of wood glue to the edges of B8 and B10 from the top of the stack to the line you just created.
- k. Place the short stack wall (B11) in position on B8 and B10.
- l. Wipe any excess glue that presses out of the joint (on the exterior surface only)
- m. Apply two small pieces of tape around this corner to help keep the joint tight.
- n. Check the alignment of the stack to ensure it is square and set it aside to dry completely (about 30 minutes).
- o. Once the stack is completely dry, remove the tape and sand off any excess glue from the corner joints.



#### Step 6: Mount the smoke stack

- a. Apply a small bead of wood glue to the exposed edges of the smoke stack underneath the short wall (pieces B8 and B10).
- b. Insert the interlocking tabs of the smoke stack into the rear wall (B2) of the main structure. It is very important for the smoke stack to be fully seated against the rear wall.
- c. Wipe any excess glue that presses out of the joint (on the exterior surface only) \*\*This is very important with this step, as there are laminate wall sections that will butt up against the smoke stack.
- d. Apply a couple pieces of tape across the smoke stack (wrapping around a window opening or the side of the structure to help hold it in place while the glue sets. \*\*If you have small clamps, feel free to use them to hold the stack in position.
- e. The glue will set completely in 30 minutes.





### Step 7: Mounting the outer laminate walls

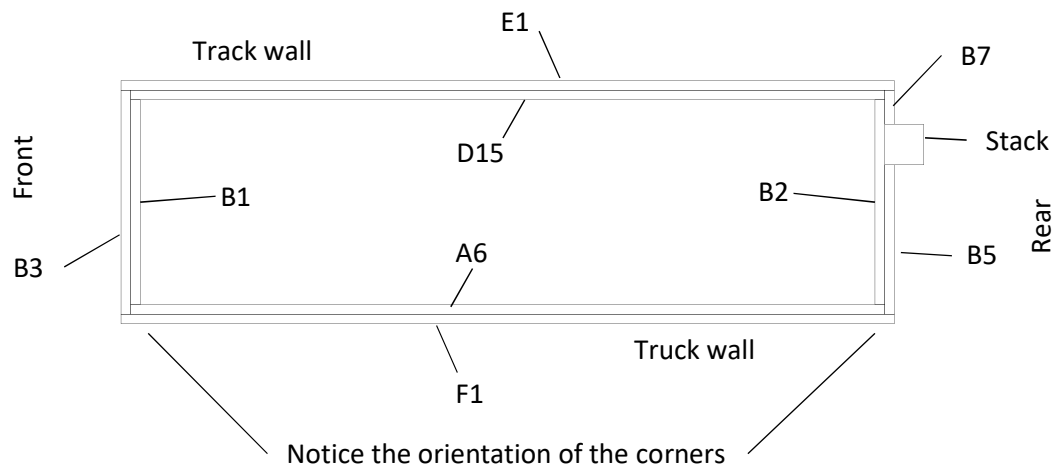

The diagram above shows the orientation of the outer laminate walls, for reference only.

### Step 8: Front Wall

*B3 Front laminate wall (1pc)*

*B4 Front raised brick laminate (1pc)*

- Stand the main structure up on the table with the smoke stack facing the benchtop (so the front wall is in the air).
- Ensure the front inner wall is free from dust and debris.



- c. Apply several small beads of wood glue on the back side of the front outer laminate wall (B3).
- d. Carefully align the front laminate wall (B3) with the front inner wall (B1). It is imperative that the top, sides and bottom of B3 be perfectly aligned with the edges of B1. Once you have it aligned perfectly set the outer laminate wall down and press firmly on the outer laminate wall to press the glue and secure it to the inner wall. Use some small clamps or tape and weights to hold the laminate wall in place while the glue sets.
- e. Apply a small bead of wood glue on the back side of the raised brick laminate. Carefully position the brick laminate over the outline engraved into the inner wall. Once you have the alignment correct set the brick laminate down and apply firm pressure to ensure the laminate wall bonds tightly with the inner wall.

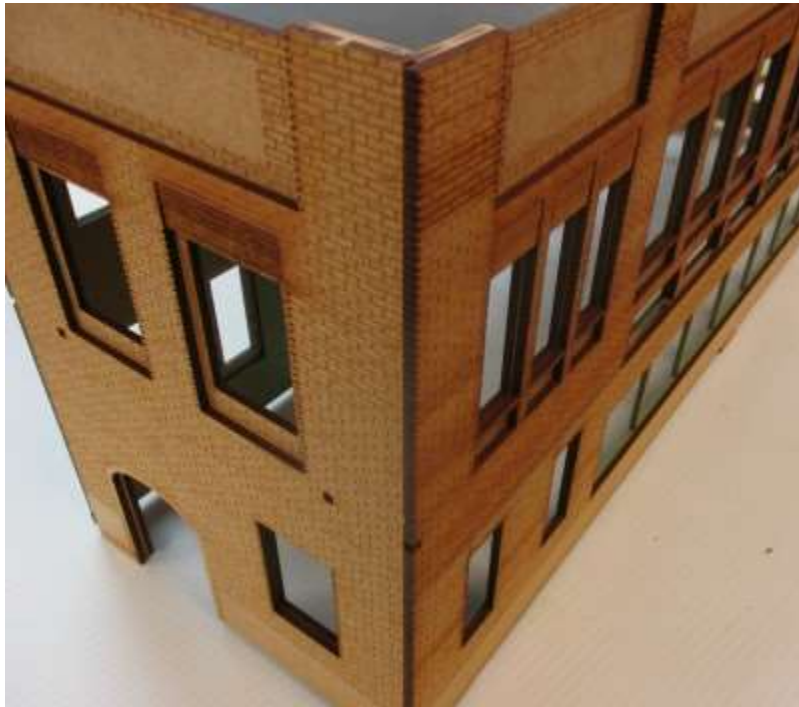

## Step 9: Rear Wall

*B5 Rear laminate wall (1pc)*

*B6 rear raised brick laminate (1pc)*

*B7 rear laminate wall (narrow) (1pc)*

- a. Flip the main structure over so the front wall is facing down on the benchtop.  
Apply several small beads of wood glue on the back side of the rear outer laminate wall (B5).
- b. Ensure the rear inner wall is free from dust and debris

- c. Carefully align the top and bottom edges of the rear outer laminate wall with the rear inner wall. The right side of the rear laminate wall will sit firmly against the smoke stack. **\*\*It is imperative the top and bottom edge align with one another.**
- d. Once the alignment is perfect set the outer laminate wall down and firmly press on it to squeeze the glue onto the bonding surface, securing itself to the inner wall surface.
- e. Apply a small bead of wood glue on the back side of the narrow rear laminate wall (B7).
- f. Ensure the rear inner wall is free from dust and debris.
- g. Carefully align the top and bottom edges of the rear laminate wall with the rear inner wall. The left side of the laminate wall will sit firmly against the smokestack.
- h. Once properly aligned, press the laminate wall firmly to squeeze the wood glue so it securely bonds with the inner wall.
- i. Apply a small bead of wood glue on the back side of the rear raised brick laminate (B6).
- j. Position the rear raised brick laminate inside the engraved outline on the rear inner wall.
- k. Once aligned, clamp the laminate wall down and apply firm pressure to ensure the wood glue bonds to the inside wall.

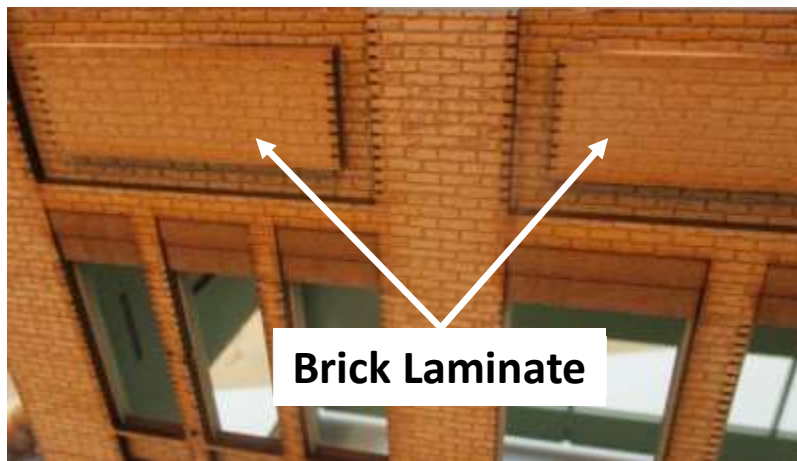

### Step 9: Truck Wall

*F1 Truck laminate wall (1pc)*

*A1, A3, A5 Short raised brick laminate (3pcs)*

*A2, A4 Long raised brick laminate (2pcs)*

- a. Lay the structure down on the table, so the roof is facing away from you and the track side of the building is facing down. This will position the front wall to your left and the smokestack to your right, the bottom of the structure will be facing you.
- b. Apply several small beads of wood glue on the back side of the truck laminate wall (F1).
- c. Ensure the inner truck wall is free from dust and debris.
- d. Carefully align the wall with the inner truck wall, paying close attention to the top edges of the walls, the bottom edges of the wall and the right and left edges of the wall. The truck laminate wall will cover the edges of the front and rear laminate walls.
- e. Once the alignment is perfect gently set the truck laminate wall down onto the inner truck wall and clamp the entire wall to ensure the adhesive bonds to the inner walls.
- f. Apply a small bead of wood glue to 5 of the raised brick laminates (A1, A2, A3, A4 & A5). Align them with the engraved outline on the inner wall, where they fit, based on their length and press firmly to secure them in place. Wait for the glue to dry.

### Step 10: Track Wall

*E1 Track laminate wall (1pc)*

*D10, D12, D14 Short raised brick laminate (3pcs)*

*D11, D13 Long raised brick laminate (2pcs)*

- a. Lay the structure down on the table, so the roof is facing away from you and the truck side of the building is facing down. This will position the front wall to your right and the smokestack to your left, the bottom of the structure will be facing you.
- b. Apply several small beads of wood glue on the back side of the track laminate wall (F1).
- c. Ensure the inner track wall is free from dust and debris.
- d. Carefully align the wall with the inner truck wall, paying close attention to the top edges of the walls, the bottom edges of the wall and the right and left edges of the wall. The truck laminate wall will cover the edges of the front and rear laminate walls.
- e. Once the alignment is perfect gently set the truck laminate wall down onto the inner truck wall and firmly apply pressure over the entire wall to ensure the adhesive bonds to the inner walls. Clamp the walls or use tape to hold it in position until the glue dries.
- f. Apply a small bead of wood glue to 5 of the raised brick laminates (A1, A2, A3, A4 & A5). Align them with the engraved outline on the inner wall, where they fit, based on their length and press firmly to secure them in place, clamp and let the glue dry.

**At this point please refer to the video for painting the main structure**

### **Step 11: Installing the lintels**

At this point in the assembly process you must decide if you want the lintel band to be a concrete color or a brick color. (This is the 1/8" square strip that separates the first story from the second story of the building). If you decide to have it be the same color as the brick on the main structure then follow the instructions below for installing it. If you decide to make it a concrete color, then skip the section below and return back to this section later.

*B12 Front wall lintel*

*B13 Rear wall lintel (long)*

*B14 Rear wall lintel (short)*

*E2 Truck wall lintel*

*F2 Track wall lintel*

- a. To keep the parts in order we suggest removing them one at a time, cleaning up the sprues so the surfaces are perfectly flat.
- b. Start with the front wall lintel (B2). Apply a small bead of wood glue to the back side of the lintel (the back side is the side with the 1/8" x 1/8" mounting tabs). Carefully place the lintel into the square mounting holes located just below the window openings.
- c. Firmly press the lintel in place and wipe up any excessive glue that squeezes out of the joint.
- d. Use a couple pieces of tape to hold the lintel firmly in place until the glue dries. It is important that there are not gaps between the lintel and the outside laminate wall.
- e. Repeat the process for both rear wall lintels (B13 and B14) using wood glue.
- f. Next move to the truck wall (E2) and repeat the process to mount the lintel, using wood glue.
- g. Finally repeat the process for the truck wall using the track wall lintel (F2).
- h. Wait 30 minutes for the wood glue to set completely. Once dry remove the tape and any remaining glue that may have squeezed out of the joint.

The diagram below illustrates how the lintels overlap one another at the corners of the structure.

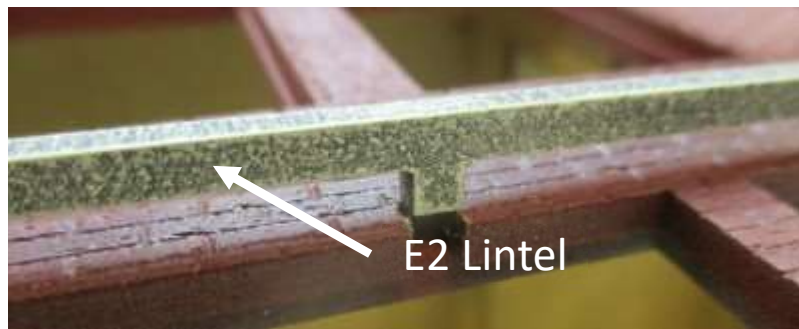
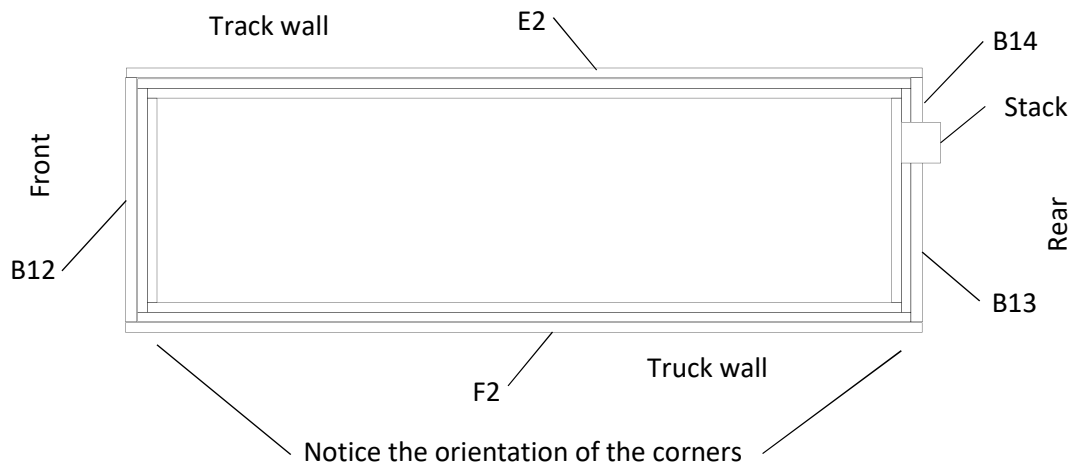

## Step 12: Installing the chimney lintels

*B15 U-shaped chimney lintels (4pcs)*

*B16 Square chimney lintels (4pcs)*

- Remove these 8 pieces from the B sheet and sand the sprue marks down so the edges are flat.
- The U-shaped lintels (B15) mount around the chimney and insert into the 1/8" x 1/8" square mounting holes in the rear laminate wall. There are 4 of these U-shaped lintels around the chimney.
- Apply a couple small dabs of super glue along the inside edge of the lintel and position the lintel in place. Make certain the lintel lines up with the mortar lines in the brick detail, so they are level.
- The square lintels (B16) slide down over the chimney itself and can be positioned in any position that suits you. No glue should be required to hold these square lintels in place.



### Step 13: Painting the main structure

At this point you should prepare to paint the main structure. You will need to do some masking to ensure the paint stays out of the interior of the structure as well as off the gray painted roof. Using masking tape and some newspaper (or cardboard) cover all the openings of the structure (windows, doors, dock doors, etc.) from the inside. Also run a bead of tape around the outside edge of the roof (where the roof and the walls meet one another, only masking off the gray roof. Cover the remainder of the roof with some scrap cardboard or newspaper to prevent any overspray from reaching the gray roof.

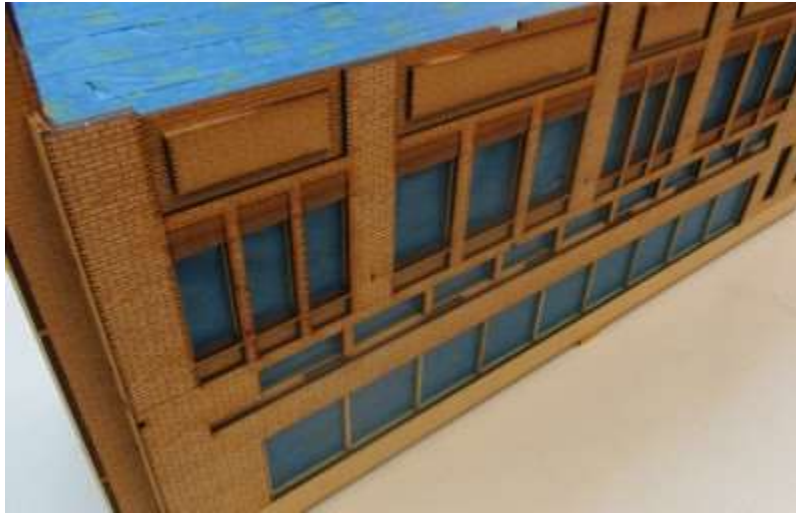

Using a can of spray paint, paint the sides of the entire structure. Apply light coats of paint to prevent runs and ensure you get all the nooks and crannies around and inside the windows, smokestack and doors. We recommend using Rustoleum® Satin Cabernet (#248635) in a spray can. It will be necessary to put multiple coats of paint on the structure, as the MDF will absorb a lot of paint on the first couple light coats. Continue painting the sides of the structure until the color is solid (and there is no bleed through of the MDF material).

Once the main structure and smokestack is completely painted and the paint has thoroughly dried you will want to mask off the 1" band on the bottom of the structure. This represents the concrete foundation and will be a concrete color when completed. Mask the red brick you just painted with tape. Cover the red walls with newspaper or scrap cardboard to prevent overspray on the red surface. Once the red brick is masked off paint the bottom concrete foundation using Rustoleum® Charcoal Gray (#7784) in a spray can. Again, a couple light coats will be required to make remove the MDF fiber texture from the finish. Allow the paint to dry thoroughly.





## Step 14: Preparing the Concrete Lintels

If you chose to paint the lintels a concrete color now is the time to prepare them for paint. There are several more pieces that need to be painted the same charcoal gray as the foundation. Locate and remove the following parts from the panels;

*D2 Corner Cap Stones (3pcs)*  
*D3 Small Cap Stones (4pcs)*  
*D4 Chimney Side Cap Stone (1pc)*  
*D5 Short Cap Stone (4" long) (1pc)*  
*D6 Short Cap Stone (4 ¾" long) (1pc)*  
*D7 Long Cap Stone (9 ½" long) (2pcs)*  
*D8 Medium Cap Stone (6 ¼" long) (4pcs)*  
*B12 Front Wall Lintel (1pc)*  
*B13 Rear Wall Long Lintel (1pc)*  
*B14 Rear Wall Short Lintel (1pc)*  
*E2 Track Wall Lintel (1pc)*  
*F2 Truck Wall Lintel (1pc)*  
*B13 Smokestack ¾ Lintel (4pcs)*  
*B14 Smokestack full Lintel (4pcs)*  
*D9 Corner Cap Stone (smokestack corner) (1pc)*

Place all of these components on a tack board (place masking tape upside down on a piece of cardboard) to hold the pieces in place while painting. You will want to paint both sides of all of these components with the Rustoleum® Charcoal Gray (#7784) same as the foundation.

Once all of these components are dry you can drybrush the gray base (before removing the masking tape) on the main structure. The same treatment can be applied to the lintels and capstones at this point (this will prevent the use of additional masking tape).

Once the foundation is dry brushed all of the masking tape on the structure should be removed at this point.

**\*\*NOTE:** If you chose to make the lintels a concrete color earlier in the assembly process, now is the time to install the lintels into the main structure. You may find it necessary to use a couple small dabs of super glue to make the lintels adhere flush to the brick work.

## Step 15: Installing the Cap Stones

*D2 Corner Cap Stones (4pcs)*  
*D3 Small Cap Stones (4pcs)*  
*D4 Chimney Side Cap Stone (1pc)*  
*D5 Short Cap Stone (4" long) (1pc)*  
*D6 Short Cap Stone (4 ¾" long) (1pc)*  
*D7 Long Cap Stone (9 ½" long) (2pcs)*  
*D8 Medium Cap Stone (6 ¼" long) (4pcs)*  
*D9 Corner Cap Stone (smokestack corner)*

The capstones should now be painted (and dry brushed) to look like weathered concrete. It is very important that the tops of the inner wall and outer wall are flush and even. Use a sanding block if necessary to make the two surfaces even BEFORE installing the cap stones. The diagram below illustrates where each of these cap stones are mounted on the top of the walls of the structure.

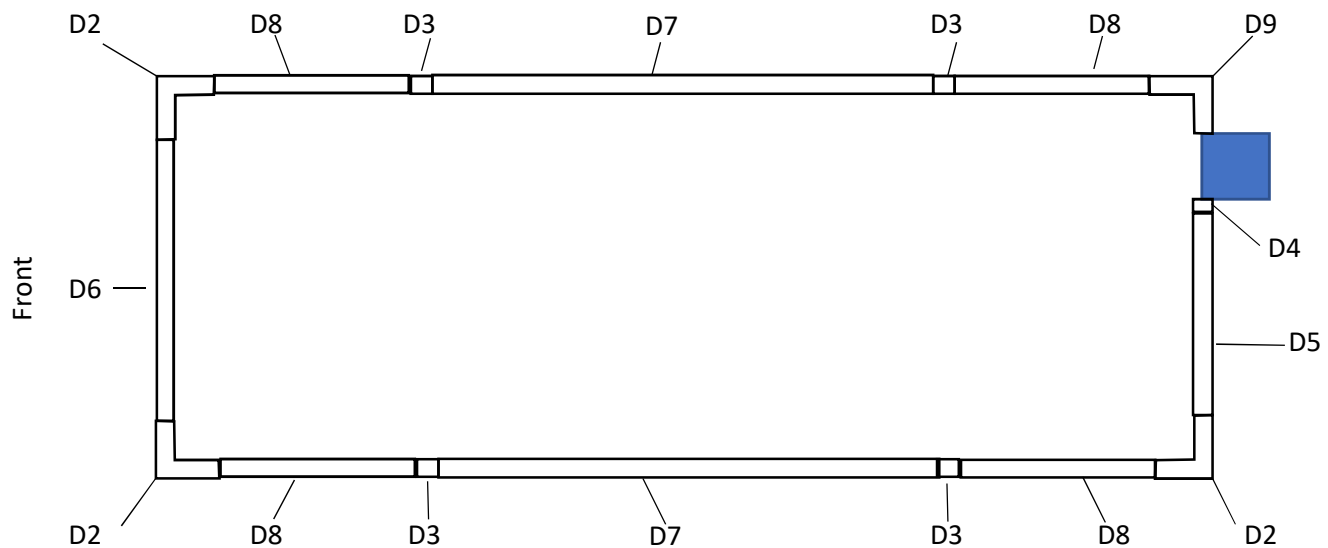

Using super glue, apply a very thin bead on the top of the wall, where you plan to position the cap stone. Press down lightly and while pressing down apply the accelerator to immediately cure the super glue. You want to center the cap stones on the tops of the laminated walls. Start in a corner and carefully work around the wall of the structure, as shown below.

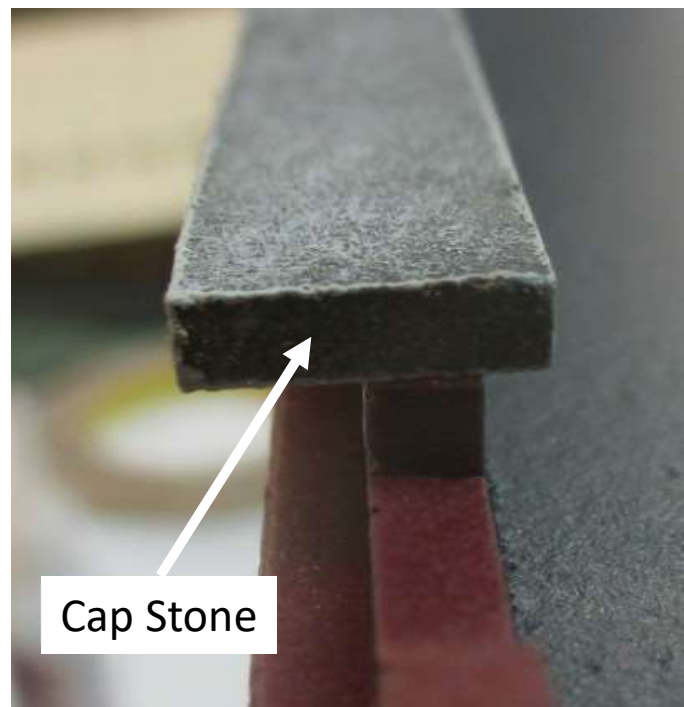
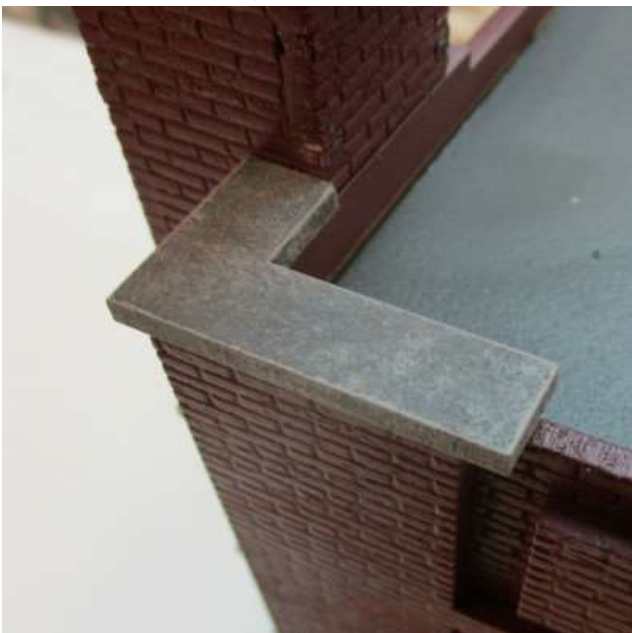

#### Step 16: Preparing the windows

*G1 Tall narrow windows (36pcs)*

*G2 Tall wide windows (20pcs)*

*G3 Front bottom window (1pc)*



*G4 Freight dock windows (24pcs)*

*H5 Main entry door (1pc)*

- a. All of these windows should be left on the large vinyl sheet for painting. Remove the main entry door from sheet H (H5), so it can be painted the same color as the other windows.
- b. We used Rustoleum® Almond (#7758) to paint the windows and entry door. Once the paint has dried thoroughly, set the windows and entry door aside for later in the assembly process.

### **Step 17: Preparing the overhead doors & rear wall panel**

*H7 Overhead Doors (18pcs)*

*H8 Rear Wall Panel (1pc)*

The overhead doors and rear wall panel should remain in the vinyl sheet. We used Rustoleum® Spruce Green (#7737) to paint the doors and rear wall panel. Once the paint has dried thoroughly it would be a good idea to paint the backside of the overhead doors with a flat black or the Spruce Green, to prevent light from shining through these doors when the building is illuminated. Once this is complete, set these aside for installation later in the assembly process.

### **Step 18: Installing the frosted vinyl “glass”**

*H1 Rear wall window frosting (1pc)*

*H2 Top story long wall window frosting (2pcs)*

*H3 Freight Dock window frosting (18pcs)*

*H4 First floor office window frosting (4pcs)*

*H6 Rear wall window frosting (1pc)*

This kit is designed so the window installation is extremely easy. This is accomplished by using frosted vinyl as the “glass” in the window openings and the windows simply press into the window openings and stick to this frosted vinyl backing. Very simple, very clean and super easy!

The window frosting must be secured to the inside of the main building using super glue. You will want to use accelerator to accelerate the super glue curing process. To install the window frosting we recommend you place the frosted vinyl onto the surface it will be mounted to and mark the edges of the vinyl on the interior surface. Then remove the vinyl, place a couple drops of super glue in the corners (and along the edges if the piece is long) then set the vinyl down into position and apply the accelerator.



Marking the outline of the vinyl on the interior wall



Applying super glue inside the vinyl outlines



Frosted Vinyl window "glass" glued inside the structure

The diagrams below illustrate where each Frosted vinyl window glass piece is located

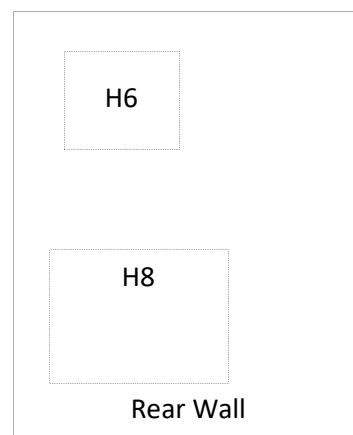
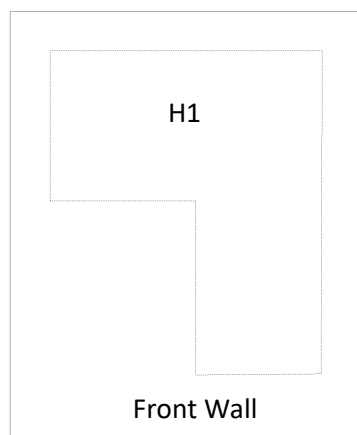
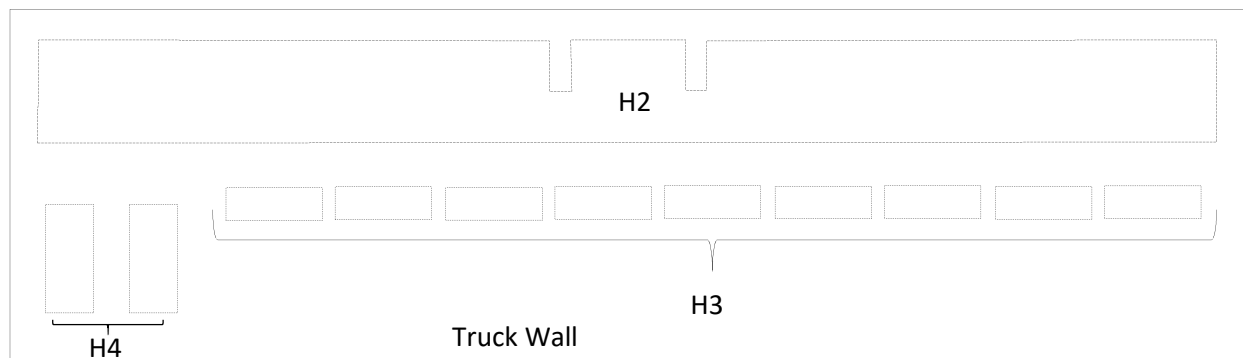

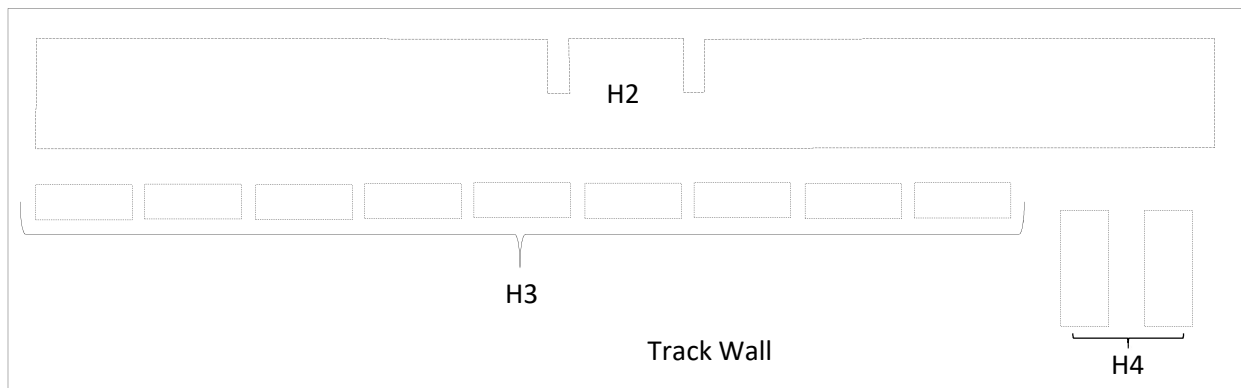

## Step 19: Installing the windows

*G1 Tall narrow windows (36pcs)*

*G2 Tall wide windows (20pcs)*

*G4 Freight dock windows (24pcs)*

Once the frosted vinyl sheets are mounted inside the structure its time to mount the windows we painted earlier. It is self-explanatory as to where each window is mounted. Simply cut the sprues that hold the window to the large vinyl sheet and carefully peel the window off the protective paper backing, being careful not to pull the adhesive tape off the window. Now, carefully position the window over top of the frosted vinyl in the window opening and gently press down around the perimeter of the window to “lock” it in place.

The windows will all fit perfectly inside the window openings. Please be sure to mount the freight dock windows with a little bit of upward pressure, to ensure the top of the window is pressing against the underside of the brick directly above the window itself (there is no bottom ledge on these windows).

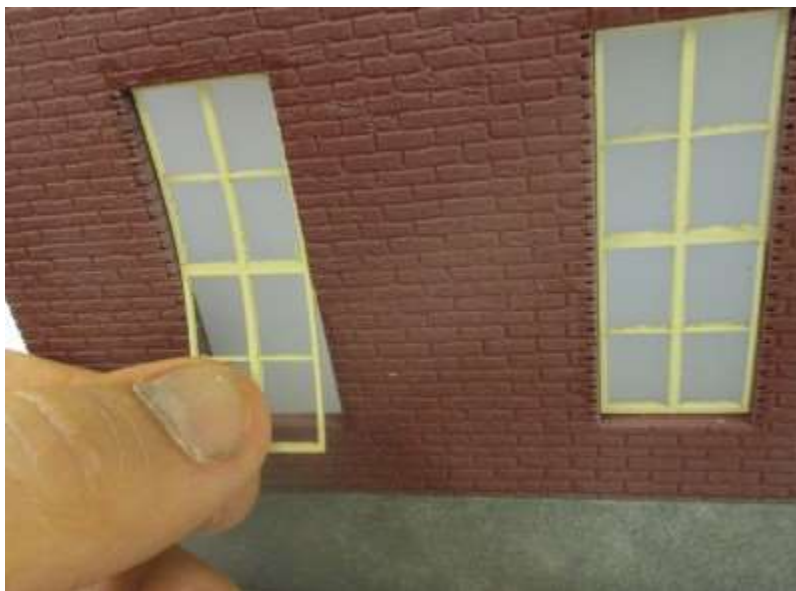

Peel and Stick the windows in their respective openings



Photo of the windows installed on the vinyl.

## Step 20: Installing the front door and front office window

*H5 Main entry door (1pc)*

*G3 Front bottom window (1pc)*

The front office window (G3) will only fit in the opening on the front wall, simply peel and stick this window onto the frosted vinyl.

The main entry door will need to be glued in place from the inside of the structure. Place four drops of super glue in the extreme corners of the front door and quickly align the bottom edge of the front door with the bottom edge of the front wall. Additionally, align both sides of the front door with the openings on the front wall. Once the door is lined up apply accelerator to speed up the curing process.



## Step 21: Install the frosted window on front door

#### *H9 Front Door vinyl frosting (1pc)*

Place a drop of super glue in each corner of the front entry door, carefully lay the front door vinyl frosting (H9) directly over top of the door and apply accelerator to speed the curing process.



Front door vinyl installed behind entry door



The front door & window, installed in the structure

#### **Step 22: Installing the rear wall door insert**

##### *H8 Rear wall door insert (1pc)*

The rear wall door (H8) insert will fit snugly onto the back side of the rear laminate wall inside an opening in the inner wall. Place four drops of super glue in each corner and carefully insert the rear wall door (H8).

## Step 23: Installing the dock doors

### *H7 Dock Doors (18pcs)*

As mentioned in the beginning of the manual, you can position these dock doors in the open or closed position. Feel free to position the doors in a variety of positions, if you desire. You will need to determine the position of each dock door prior to installing them. As the doors are large enough to be positioned all the way down, however, when in the open position they begin to encroach upon the dock windows; so each open dock door will need to be cut, so it does not overlap the dock windows.

The doors should be scribed with an X-Acto knife along the engraved horizontal lines that represent the joints in the door panels. Then they will snap apart very easily after being scored twice.

**\*\*NOTE:** when positioning the doors in the closed position do not go any further than the top of the dock floor on the inner wall! (Otherwise the dock floor will not fit inside the structure properly.)

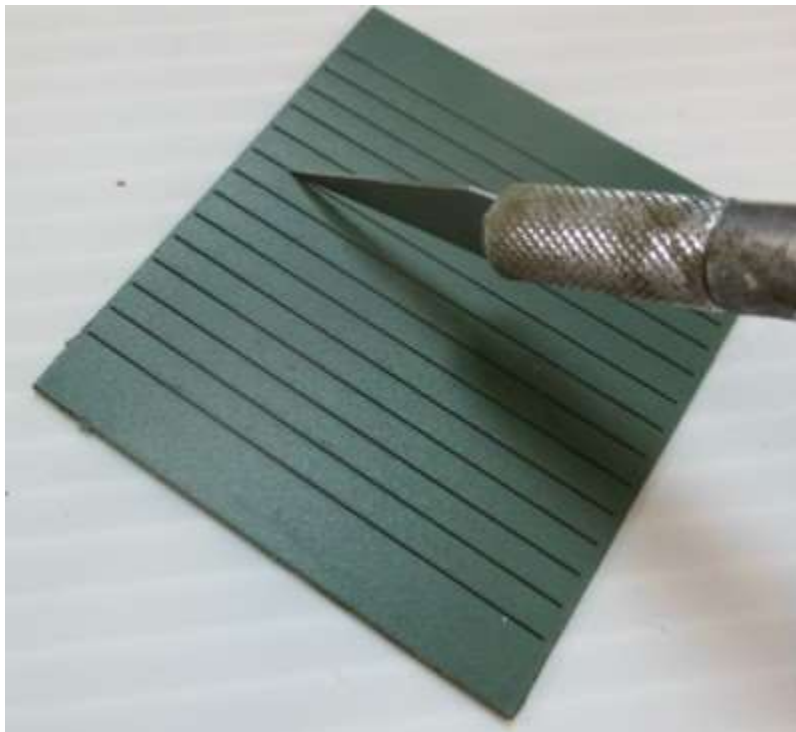

Scribing along the panel lines to create a shorter door

Only apply super glue to the area above the doors, the face of the horizontal supports is too narrow to accommodate super glue without it pressing out on the door and creating an unwanted mar.

Determine the position of each door prior to gluing them into position! Once you like the positioning of the doors mark the top of each door as a guide for where to place the super glue.

Use the accelerator to speed up the drying time of the super glue.



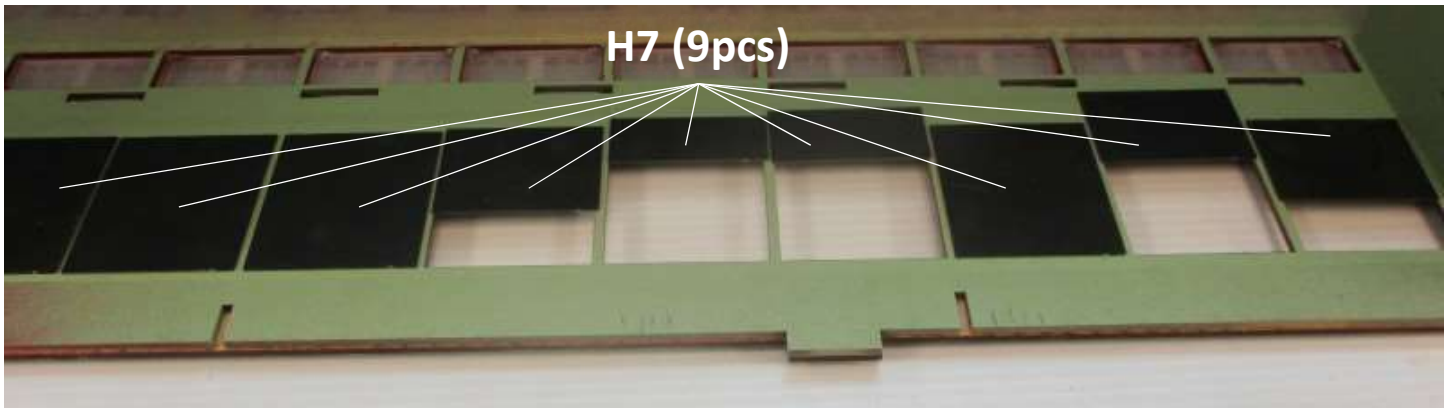

Complete both sides of the dock, installing a total of 18 dock doors.

#### **Step 24: Installing the dock canopies**

*A8 Dock Canopy (1pc)*

*D1 Dock Canopy (1pc)*

*1/16" Diameter brass rods (10pcs)*

The dock canopies will only fit on their respective sides.

- a. Insert the tabs on the dock canopy into the wall of the structure. Ensure the tabs are fully inserted into the wall.
- b. Gently press upward on the dock canopy so it sits flush with the top of the tab openings (yes, there will be a gap underneath the canopy in the tab openings, this is okay).



- c. Now locate the separately packaged brass rods. Insert one end of the rod into the dock canopy and gently lift the canopy upwards (on an angle) until you can insert the brass rod into the round opening on the brick wall (the holes on the canopy are aligned with the holes on the brick walls). The canopy is designed to be angled upwards and the brass rods hold the canopy in this position.



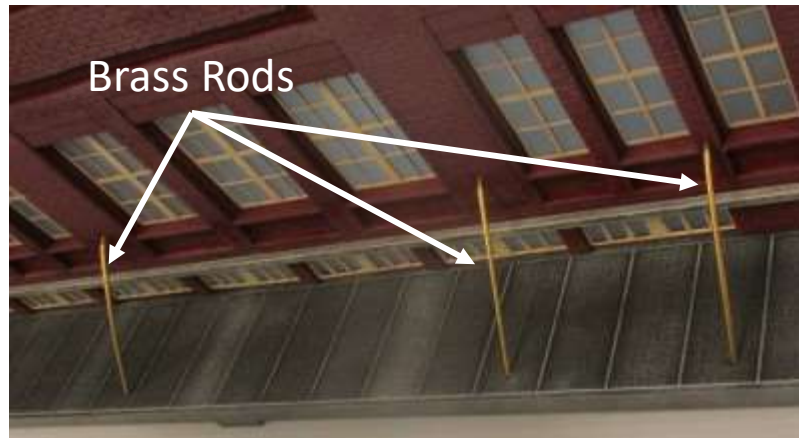

- d. Repeat the installation of the brass rods until all 5 rods are in place between the canopy and the wall.
- e. Once the brass rods are in position go back and ensure the top of the canopy tabs are flush with the top of the canopy tab holes on the brick wall. The canopy **MUST** sit flush with the top of the tab holes in the wall, so there is no light shining through!
- f. You can glue the tabs in place on the inside of the wall if necessary, as the photo below illustrates;



- g. Once the canopies are properly positioned it may be necessary to apply a small dab of super glue to the brass rods to ensure they stay in place in the canopy and / or the brick wall.
- h. Once you are satisfied with the positioning of the canopies use a small pair of side cutters to remove any excess brass protruding underneath the canopy surface.

## Step 25: Applying gravel to the roof

Fine gray gravel (8oz)

- a. Using white glue (or scenery cement) and a throw away brush spread an even coat of glue over top of the entire roof surface. It is important that you get an even coat on the entire surface.
- b. Take the separately packaged gravel and dump it onto the center of the roof surface. Carefully lift the structure up and tilt it back and forth, front to back until you have an even coating of gravel over top of the entire roof surface. You will most likely have additional gravel left over, which is okay. This additional gravel can be vacuumed off when the glue dries completely.
- c. Once the glue has completely set up you can either dump the additional gravel into a trash can or vacuum it off using a shop vac. The gravel should cover the entire surface of the roof.
- d.

## Step 26: Installing the floor & foundation

*Dock Floor (1pc)*

*¼" Foundation (1pc)*

- Locate the dock floor you assembled in the beginning of the build. Insert the supports for the dock floor into the tabs in the base of the structure. NOTE: The floor only installs in one direction!
- Once you have the dock floor inserted into the base of the building set the entire building down onto the foundation. The wider sidewalk goes toward the front of the building with the main entrance door.
- The building and the floor are designed to “sit” on the foundation. This allows you to remove the dock floor, should you want to provide any interior details; crates, boxes, forklift figures, etc. The floor can be removed to add these details, then be repositioned inside the structure and set back down on the foundation.

## Step 27: Truck Dock Bumpers

D16 Dock Bumpers (9pcs)

- Paint the dock bumpers a flat black color before installing them below.
- Glue the dock bumpers in position below the dock doors on the Truck Wall side of the structure (F1). Center the bumpers in the center of the door opening and use super glue to hold them in place.



Your Rock Island Freight House kit is now complete! We hope you enjoyed this kit and look forward to offering more unique structures in the future. Please check our blog at <https://blog.traindame.com> for future offerings!

Completed photos:



Available now!

TWX-2010 Concrete Coaling Tower kit (kit price \$517.00)



**Also available Built, Painted & Weathered price: \$1827.00**